



NEXUS[®] SHUTTLE BIN

Operator Instruction Leaflet

IMPORTANT NOTE: ENSURE THAT ALL RELEVANT PERSONNEL READ THESE INSTRUCTIONS PRIOR TO USE

To Open and Close Lid (Sack Retention or Solid Liner Model)

1.

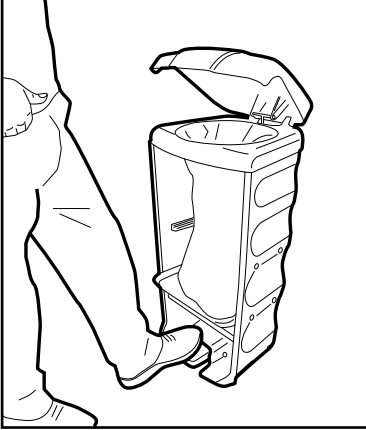

Using your foot, push downwards onto the pedal allowing the lid to rise.

2.

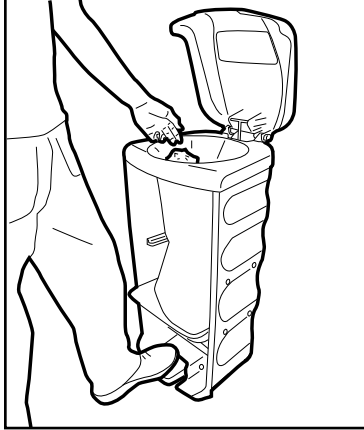

With your foot still on the pedal, place food waste into the aperture.

3.

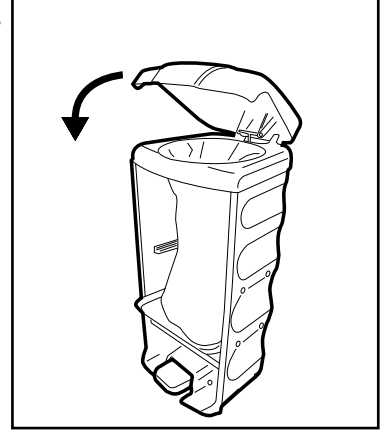

Remove your foot from the pedal to allow the lid to close softly.

To Keep Lid in an Open Position for Emptying/Replacing Sack (Sack Retention or Solid Liner Model)

4.

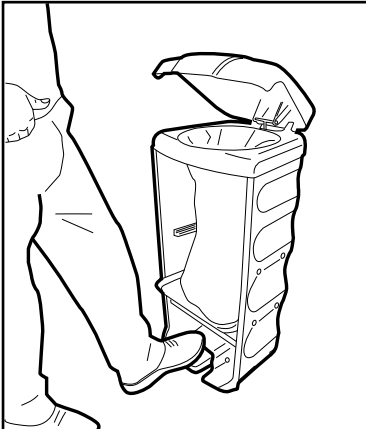

Repeat Step 1.

5.

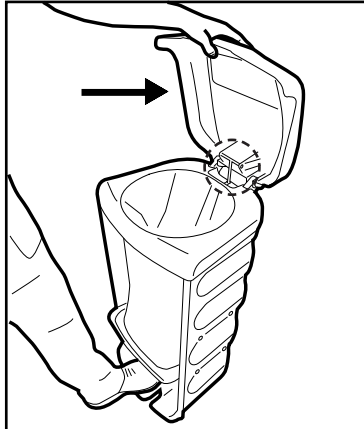

With your foot still on the pedal, push the lid backwards so that it locates within the recess.

6.



To close the lid, pull forwards towards you.

To Secure a Sack in Position (Sack Retention Model)

7.

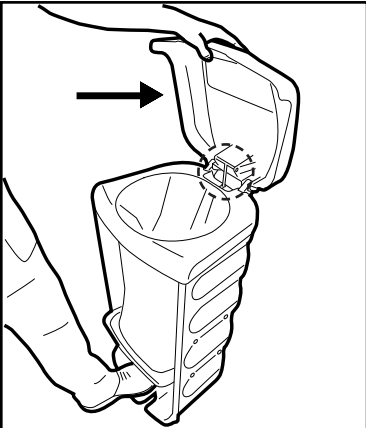

Repeat Steps 4 & 5 to allow the lid to remain in the open position.

8.

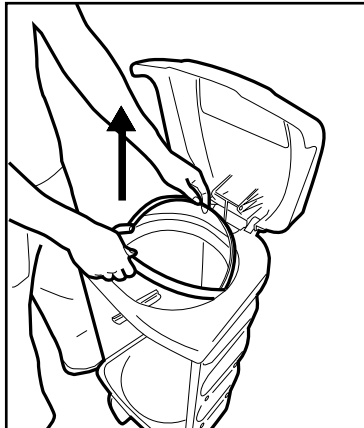

Pull the sack bands upwards from the aperture.

9.



Pull the sack up through the aperture and wrap over the sack bands.



NEXUS[®] SHUTTLE BIN

Operator Instruction Leaflet

To Secure a Sack in Position (continued)

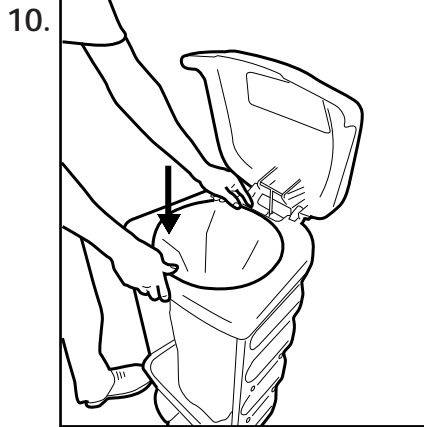

Push the sack bands down into the aperture so that the sack is held securely and neatly. Ensure that the sack is sat within the bin body behind the support bar or in the centre of the shelf.

To Empty the Sack (Sack Retention Model)

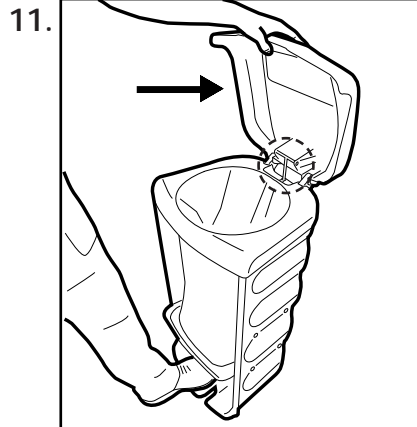

Repeat Steps 4 & 5 to allow the lid to remain in the open position.

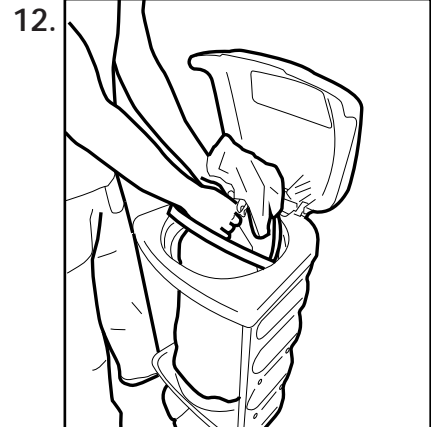

Pull the sack bands upwards to release the sack.

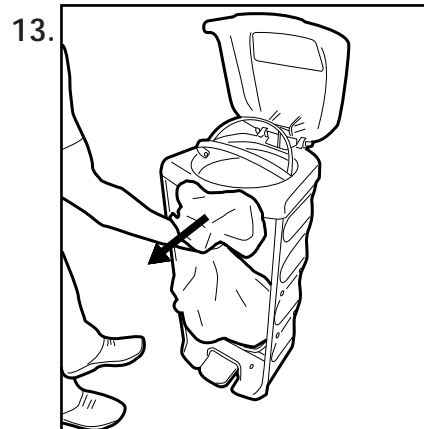

Pull the sack out of the body towards you for minimal manual handling.



Replace the bin with a new sack following steps 7 - 10.

To Remove and Adjust Height of Shelf (Sack Retention Model)

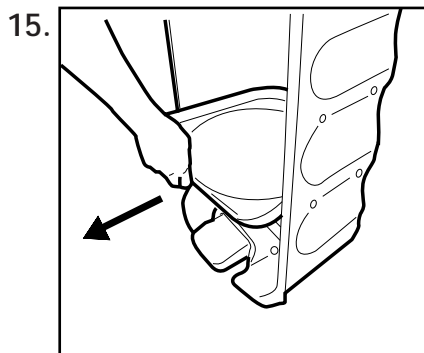

Using the lip of the shelf, pull the shelf towards you.

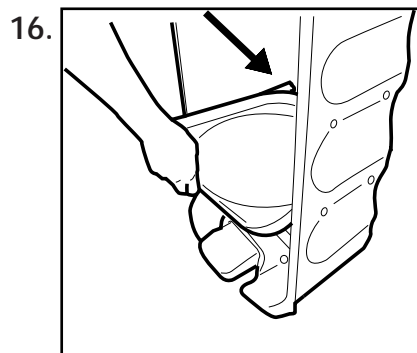

Sit the shelf on top of the relevant brackets.

Note: The shelf is dishwasher safe.



NEXUS[®] SHUTTLE BIN

Operator Instruction Leaflet

To Remove, Empty, and Replace Solid Liner (Solid Liner Model)

17.



Follow steps 4 & 5 to allow the lid to remain in the open position.

18.



Place one hand under the lip on the front of the liner and pull towards you to remove the liner from the bin body.

19.



Push the liner lid firmly down onto the liner. (Liner lid is dishwasher safe). This will keep the food contained when being moved or if being stored for emptying at a later time.

20.



Place both hands onto the liner handles and tilt the liner towards you allowing it to be wheeled.

21.



Once at the disposal area, place one hand onto a liner handle and one into the base recess. Lift the liner to empty.

22.

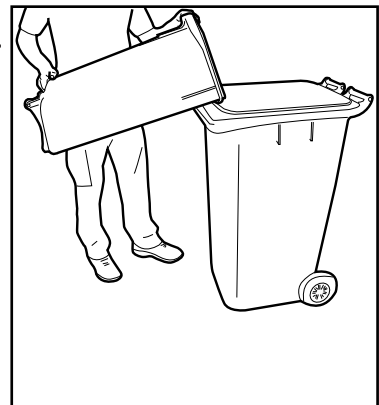

Using the lip of the liner, hook this onto the edge of the wheeled bin (example) and tip the liner to empty the food.

23.



After jet washing the liner, follow step 20 to wheel the liner back to the bin body.

24.



If the bin lid is closed, follow steps 4 & 5 to allow the lid to remain in the open position.

25.





NEXUS[®] SHUTTLE BIN

Operator Instruction Leaflet

Using Bungee Cord to Secure Sack in Solid Liner (Solid Liner Model)

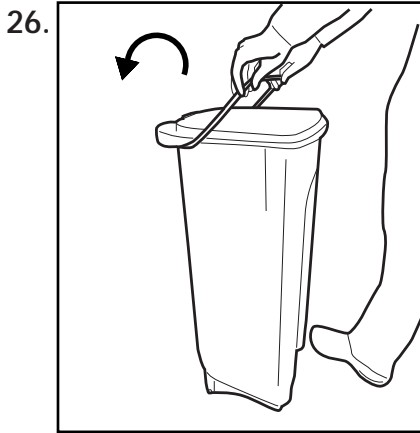

Remove the bungee cord from around the liner by pulling up and over.



Place the sack inside the liner ensuring that the sack overhangs the liner rim.



Pull the bungee cord over the sack so that it sits underneath the rim of the liner.

Attaching A4 Sign Kit

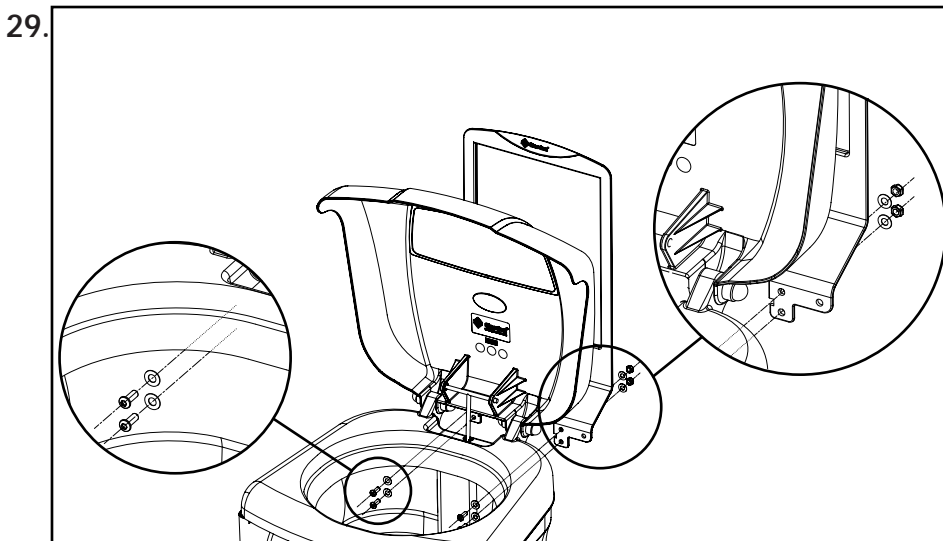

Remove solid liner from bin, if applicable. Position the sign carrier at the rear of the bin so that the holes are aligned with the holes in the bin. From inside the bin place 4 off screws and washers provided through the holes and fix on the back of the bin with 4 off washers and nyloc nuts. Using a 10mm spanner and allen key tighten nuts until secure.

Inserting A4 Sign

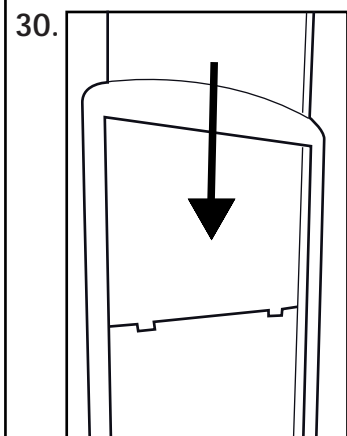

Place A4 sign behind the clear polycarbonate sheet and slide into the sign carrier so that the lugs locate into the slots along the bottom of the sign carrier.



AND NEXUS[®] SHUTTLE BIN ARE TRADEMARKS OF GLASDON GROUP OR ITS SUBSIDIARIES IN THE U.K. AND OTHER COUNTRIES

- A planned maintenance schedule of regular inspection is recommended, replacing components as necessary.
- Replacement components are available direct from GLASDON UK LIMITED.
- GLASDON UK LIMITED cannot be held responsible for claims arising from incorrect installation, unauthorised modifications or misuse of the product.

Issue 2 January 2014 C000/0427
© Copyright January 2014
Glasdon UK Ltd reserve the right to alter specifications without prior notice.



Glasdon

Glasdon U.K. Limited

Preston New Road
BLACKPOOL
Lancashire FY4 4UL
Tel: 01253 600410
Fax: 01253 792558
email: sales@glasdon-uk.co.uk
web: www.glasdon.com